

CUTTING NOTES:

BY FOLLOWING THE PRESCRIBED CUT DIMENSIONS (2) LEDGE BLOCKS WILL YIELD (1) 90° CORNER ASSEMBLY WITH MINIMAL WASTE.

**DISCARD THIS PORTION**

3  
41

CUTTING DIAGRAM  
(TOP VIEW FULL BLOCK)  
SCALE: 1" = 1'-0"

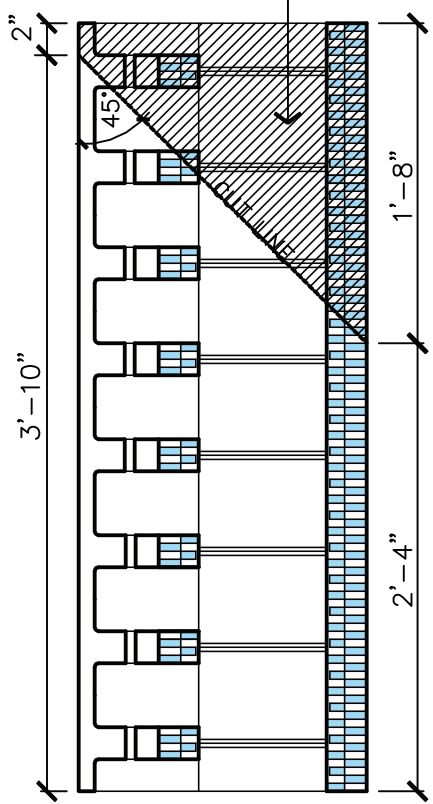

1  
41

PERSPECTIVE VIEW  
NO SCALE

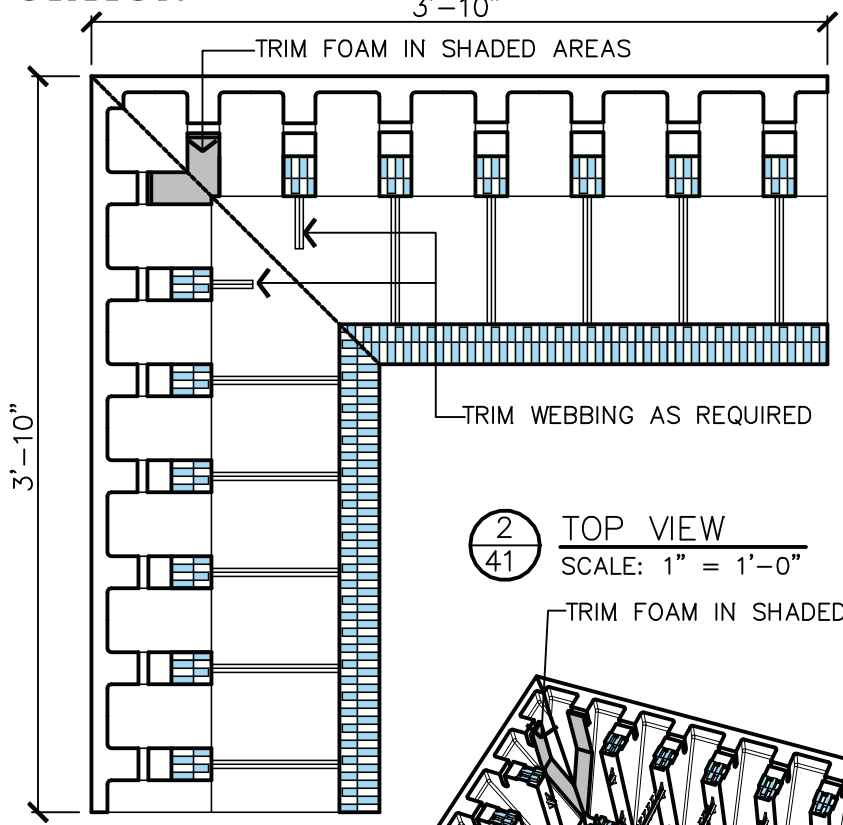

2  
41

TOP VIEW  
SCALE: 1" = 1'-0"

TRIM FOAM IN SHADED AREAS

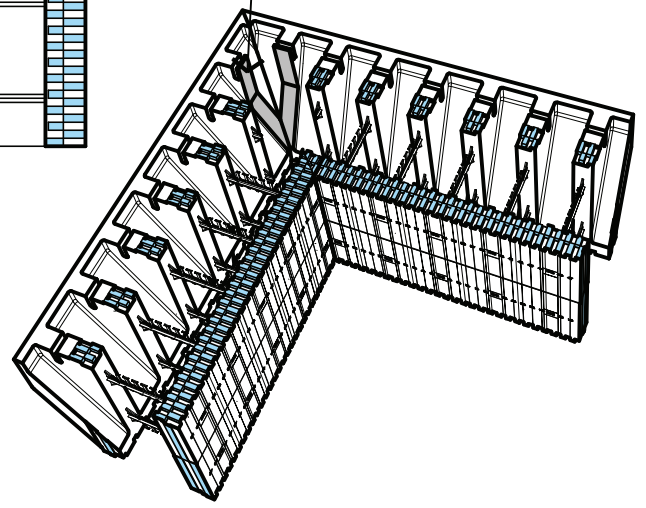

NOTE:

DUE TO VARIATIONS IN SELECTED PRINTER SETTINGS, NOTED SCALES MAY NO LONGER BE APPLICABLE



8" LEDGEBLOCK OUTSIDE 90° MITER NO. 1

DATE/REV	03-15-06 /1	SCALE	NTS	DETAIL SHEET
----------	-------------	-------	-----	--------------

NOTES				
-------	--	--	--	--

9705 N. BROADWAY EXTENSION, SUITE 200, OKLAHOMA CITY, OK 73114  
OFFICE: 405-840-3386 | TOLL FREE: 866-222-2575 | FAX: 831-597-0792  
BUILDBLOCK.COM

CONSTRUCTION SHALL BE IN ACCORDANCE WITH ALL APPLICABLE LOCAL AND NATIONAL CODES. ALL DRAWINGS ARE SUBJECT TO CHANGE WITHOUT NOTICE.

**41**