

ICF LEDGER CONNECTOR SYSTEM  
AS MFG. BY "SIMPSON STRONG-TIE INC.)

FLOOR SYSTEM PER  
CONSTRUCTION DRAWINGS

CONTINUOUS LEDGER BOARD  
SUBSTRATE AS REQUIRED

SIDING - VINYL, WOOD, CEMENT  
BOARD OR OTHER AS SPECIFIED  
(ADDITIONAL SUBSTRATES  
MAY BE REQUIRED)

GRADE LEVEL  
(1ST FLOOR OR  
ADDITIONAL STORIES)

APPROVED JOIST HANGER

OVERLAP 40 DIAMETERS

CEMENTIOUS POLYMER COATING  
FOR SIDING NOT APPROVED FOR  
GROUND CONTACT - EXTEND BELOW  
GRADE AS REQ'D BY LOCAL CODES  
SLOPE FINISHED GRADE  
AWAY FROM BUILDING

CRAWL SPACE

CUT & BOX OUT FORMS  
AT REQUIRED CODE  
ACCESS & VENTILATION  
PANELS  
APPROVED 15 MINUTE  
FIRE BARRIER WHERE  
REQUIRED BY CODE

NUMBER OF COURSES AS REQUIRED  
FOR REGIONAL FOUNDATION DEPTHS  
AS PRESCRIBED BY LOCAL CODES

18" MIN. OR PER  
LOCAL CODES

"BuildBlock" 6" OR 8"  
UNITS - REINFORCING PER  
SPECIFICATIONS

VERTICAL REBAR PER  
DESIGN - SEE ENGINEERING  
GUIDELINES - SPACE PINS EQ.  
W/ VERTICAL STEEL IN WALLS

CONCRETE FOOTING -  
REINFORCING PER  
CONSTRUCTION  
DRAWINGS

1'-6"

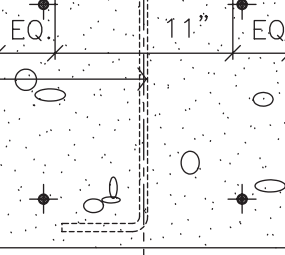

EQUAL 1'-6" EQUAL 3"

⊕ FOOTING - DIMENSIONS  
SHOWN ARE MIN. STANDARD  
- ADJUST AS REQUIRED  
FOR SOIL CONDITIONS AND  
PER LOCAL CODES

**NOTES:**

1. VARIATIONS IN IMPOSED LIVE & DEAD LOADS AND OTHER APPLICATION SPECIFIC VARIABLES REQUIRE ALL ASPECTS OF THE DETAILS SHOWN HERE TO BE DESIGNED AND /OR APPROVED BY A QUALIFIED ENGINEER
2. ALL CONSTRUCTION SHALL BE IN ACCORDANCE W/ THE SPECIFICATION OF AND THE RESPONSIBILITY OF A QUALIFIED STRUCTURAL ENGINEER.
3. INSTALL APPROVED MEMBRANE WATER-PROOFING AT ALL SURFACES BELOW GRADE EXTEND 12" MIN. ABOVE FINAL GRADE

**NOTE:**

DUE TO VARIATIONS IN SELECTED  
PRINTER SETTINGS, NOTED SCALES  
MAY NO LONGER BE APPLICABLE

1  
23d

**DETAIL CROSS SECTION**

SCALE: 1" = 1'-0"



**SIDING ON BUILDBLOCK CRAWL SPACE**

DATE/REV	11-17-09	SCALE	NTS	DETAIL SHEET
----------	----------	-------	-----	--------------

NOTES	
-------	--

9705 N. BROADWAY EXTENSION, SUITE 200, OKLAHOMA CITY, OK 73114  
OFFICE: 405-840-3386 | TOLL FREE: 866-222-2575 | FAX: 831-597-0792  
BUILDBLOCK.COM

CONSTRUCTION SHALL BE IN ACCORDANCE WITH ALL APPLICABLE  
LOCAL AND NATIONAL CODES. ALL DRAWINGS ARE SUBJECT TO  
CHANGE WITHOUT NOTICE.

**23D**