

# ICF Connectors

The following spacing tables are an alternative to the ICFVL Spacing to Replace Anchor Bolts tables or allowable loads on page 5. They give the spacing of our ICFVL Ledger Connectors based on the allowable vertical load of the connector, the load on the floor and the span of the joists. The designer must determine the design load, the ledger design and joist design. This table is useful if the designer already has loads and spans, but not necessarily anchor bolt spacing.

Uniform Loads		ICFVL Spacing for Wood Ledger (in)									
Dead Load (PSF)	Live Load (PSF)	Joist Span (ft)									
		10	12	14	16	18	20	22	24	26	28
10	40	48	48	48	48	48	47	42	39	36	33
15	40	48	48	48	48	47	42	38	35	33	30
20	40	48	48	48	48	43	39	35	32	30	28
10	60	48	48	48	42	37	33	30	28	26	24
20	60	48	48	42	36	32	29	26	24	22	21
30	60	48	43	37	32	29	26	24	22	20	18
40	60	47	39	33	29	26	23	21	19	18	17
10	100	42	35	30	26	24	21	19	18	16	15
20	100	39	32	28	24	22	19	18	16	15	14

See notes below.

Uniform Loads		ICFVL Spacing for Steel Ledger (in)									
Dead Load (PSF)	Live Load (PSF)	Joist Span (ft)									
		10	12	14	16	18	20	22	24	26	28
10	40	48	48	48	48	44	40	36	33	31	28
15	40	48	48	48	45	40	36	33	30	28	26
20	40	48	48	47	42	37	33	30	28	26	24
10	60	48	47	41	36	32	28	26	24	22	20
20	60	48	42	36	31	28	25	23	21	19	18
30	60	44	37	32	28	25	22	20	18	17	16
40	60	40	33	28	25	22	20	18	17	15	14
10	100	36	30	26	23	20	18	16	15	14	13
20	100	33	28	24	21	18	17	15	14	13	12

1. Values shown are maximum spacing distances (in) based on simple span, uniformly loaded conditions and do not consider concentrated loads.
2. Joist and ledger are to be designed by others.
3. Allowable loads are based on testing, with no further increases allowed.
4. Tables above address vertical loads only. If connection is designed to resist lateral loads, spacing will decrease. Contact Simpson for current information.

Simpson offers many retrofit products for attaching wood or steel framing members to concrete. For expanded details contact us at (800) 999-5099 and request the current Simpson Anchor Systems catalog, or visit the Simpson Anchor Systems website at [www.simpsonanchors.com](http://www.simpsonanchors.com).

### Alternative Retrofit Solution for Direct Attachment of Joist to Wall

The HU and HUC hangers are heavy duty face mount joist hangers made from 14 ga galvanized steel. These hangers can be directly attached to concrete wall using 1/4x1 3/4" Titen Hex Head screws. See Simpson technical bulletin T-ANCHORSPEC for more information on installation and use.

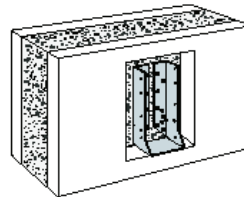

HUC410  
Installed on  
face of concrete  
in ICF

*This flyer is effective until January 31, 2008, and reflects information available as of December 1, 2005. This information is updated periodically and should not be relied upon after January 31, 2008; contact Simpson for current information and limited warranty or see [www.strongtie.com](http://www.strongtie.com).*

Home Office  
4120 Dublin Blvd., Ste 400  
Dublin, CA 94568  
FAX: 925/833-1496

Southwest USA  
260 N. Palm Street  
Brea, CA 92821  
FAX: 714/871-9167

Southeast USA  
2221 Country Lane  
McKinney, TX 75069  
FAX: 972/542-5379

Eastern Canada  
5 Kenview Blvd.  
Brampton, ON L6T 5G5  
FAX: 905/458-7274

Warehouses:  
Enfield, CT  
Jacksonville, FL  
Kent, WA  
Langley, BC

800-999-5099  
[www.strongtie.com](http://www.strongtie.com)

Northwest USA  
5151 S. Airport Way  
Stockton, CA 95206  
FAX: 209/234-3868

Northeast USA  
2600 International Street  
Columbus, OH 43228  
FAX: 614/876-0636

Quik Drive Factory  
436 Calvert Drive  
Gallatin, TN 37066  
FAX: 615/451-9806

Western Canada  
11476 Kingston St.  
Maple Ridge, BC V2X 0Y5  
FAX: 604/465-0297

© Copyright 2005 Simpson Strong-Tie Company, Inc.

Printed in the USA

F-ICFVL06 12/05 exp. 1/08

DETAIL SHEET CONTAINS SPECIFICATIONS AND DETAILS PROVIDED BY SIMPSON STRONG-TIE INC. BUILDBLOCK ASSUMES NO LIABILITY FOR THE USE OF ANY INFORMATION PROVIDED BY THE MANUFACTURER. IT SHALL BE THE USERS RESPONSIBILITY TO VERIFY THE CURRENT STATUS AND APPLICATION CHANGES WITH THE MANUFACTURER. CONTACT: ON-LINE WWW.STONGTIE.COM - ENGINEERING SUPPORT AT 1-800-999-5099



9705 N. BROADWAY EXTENSION, SUITE 200, OKLAHOMA CITY, OK 73114  
OFFICE: 405-840-3386 | TOLL FREE: 866-222-2575 | FAX: 831-597-0792  
BUILDBLOCK.COM

## SIMPSON ICF CONNECTORS

DATE/REV 03-12-07 / 1

SCALE NTS

DETAIL SHEET

NOTES

CONSTRUCTION SHALL BE IN ACCORDANCE WITH ALL APPLICABLE LOCAL AND NATIONAL CODES. ALL DRAWINGS ARE SUBJECT TO CHANGE WITHOUT NOTICE.

# 15E