

1 BR0612 - 12 FT ARC VIEW

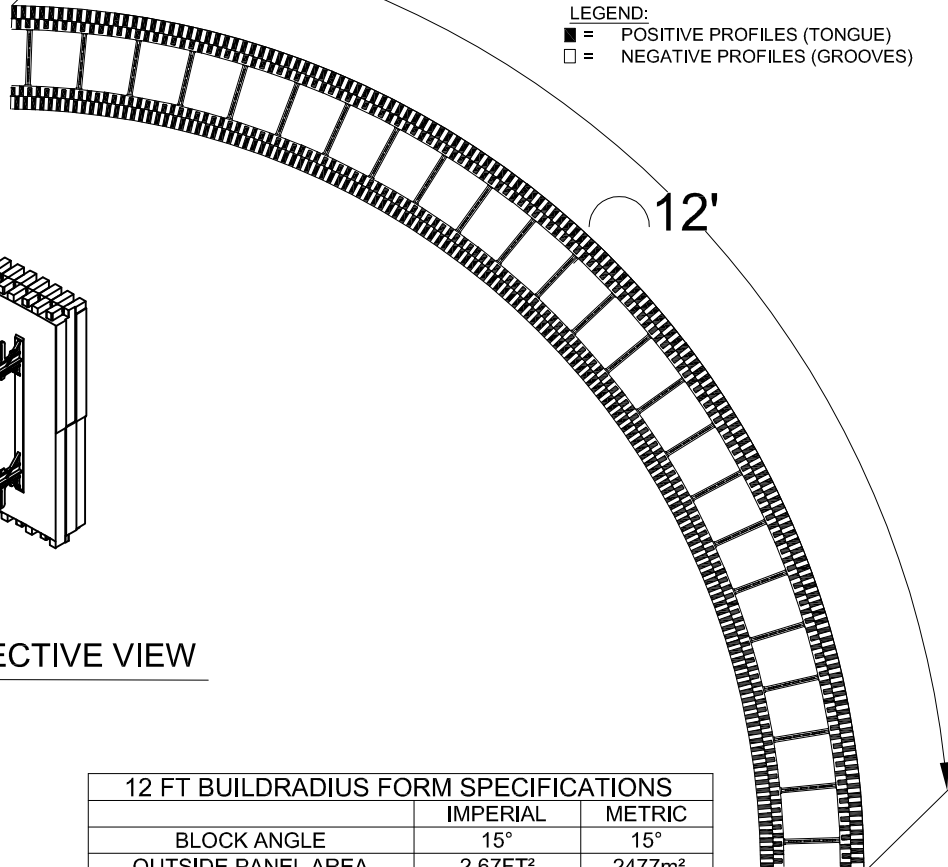

LEGEND:  
 ■ = POSITIVE PROFILES (TONGUE)  
 □ = NEGATIVE PROFILES (GROOVES)

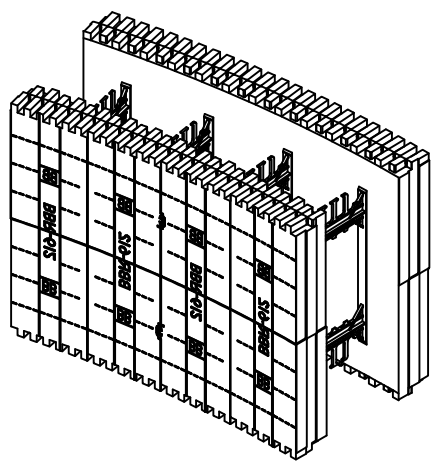

2 BR0612 - PERSPECTIVE VIEW

12 FT BUILD RADIUS FORM SPECIFICATIONS		
	IMPERIAL	METRIC
BLOCK ANGLE	15°	15°
OUTSIDE PANEL AREA	2.67FT <sup>2</sup>	.2477m <sup>2</sup>
INSIDE PANEL AREA	2.35FT <sup>2</sup>	.2180m <sup>2</sup>
OUTER PANEL ARC LENGTH	2FT 0IN	60.96M
INNER PANEL ARC LENGTH	1-FT 9-1/8-IN	54CM
OUTER RADIUS	7-FT 7-11/16-IN	232.85CM
INNER RADIUS	6-FT 8-11/16-IN	204.82CM
STRAIGHT SECTION LENGTHS	0-IN	0-CM
CONCRETE VOLUME	0.04642 YD <sup>3</sup>	0.035490 m <sup>3</sup>

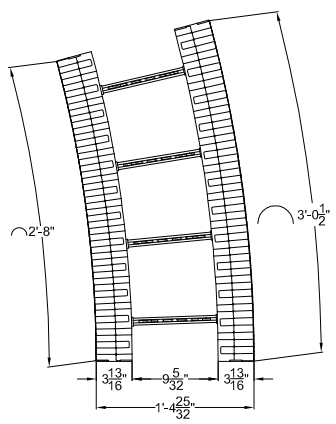

3 BR0612 - TOP VIEW

NOTES:

1. BUILD RADIUS FORMS ARE SIZED BY THE LENGTH OF THE OUTER PANEL AT 90° ARC. THE RADIUS AND DIAMETER OF THE FORMS ARE GIVEN IN THE ACCOMPANYING CHART.
2. TO CREATE A RUNNING BOND WHEN INTEGRATING WITH A STRAIGHT BLOCK WALL, CUT THE FORM IN HALF, VERTICALLY AT THE CENTERLINE (CL) USING ONE HALF OF THE BLOCK AT EACH END ON EVERY COURSE.
3. BLOCK COURSING 1'-4".

12 FOOT RADIUS FORM

DATE / REVISION / BY	7-1-23 / 1 / AQ
SCALE	NTS
FILE NAME	1.505 - BR612