



Home Stretch™

Peel 'N Stick Membrane

Installation Instructions

STEP 1

Apply the Home Stretch Peel 'N Stick Membrane waterproofing system onto vertical insulated concrete form (ICF) walls, cast-in-place concrete walls, concrete masonry (CMU) walls, or precast concrete foundation walls.



STEP 2

The substrate foundation and walls must be clean; dry; clear of dirt, debris, frost, smears, and concrete form release agents; and be allowed to cure a minimum three (3) days prior to the application of the Home Stretch Peel 'N Stick Membrane waterproofing system.



POLY WALL® BUILDING SOLUTIONS:
Moisture and Air Stop Here®
888-976-POLY (7659) • www.poly-wall.com





Home Stretch™

Peel 'N Stick Membrane

Installation Instructions

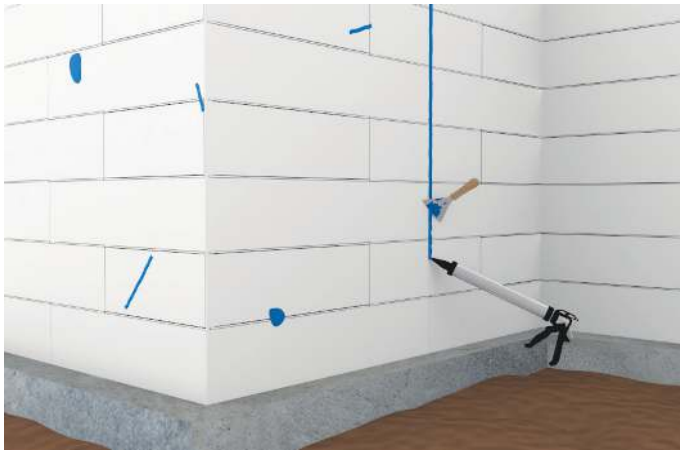

STEP 3

Minor voids in the foundation wall, as well as wall control joints, are to be filled and sealed with Poly Wall Blue Barrier 2200 Joint Filler to provide a level plane for the application of the Home Stretch Peel 'N Stick Membrane waterproofing material. Allow the Blue Barrier 2200 Joint Filler a minimum two (2) hours to skin over before covering with the Home Stretch Peel 'N Stick Membrane, adding additional time for lower ambient and surface temperatures. Stir the liquid adhesive prior to use. Use Poly Wall Polybond Clear Liquid Adhesive for cast-in-place concrete walls, concrete masonry (CMU) walls, or precast foundation walls. Use Poly Wall Home Stretch WB Liquid Adhesive for insulated concrete form (ICF) walls. Field test the Poly Wall Home Stretch WB Liquid Adhesive on the substrate wall to determine the adhesion level.



STEP 4A

If Home Stretch Peel 'N Stick Membrane is continued at the base of the foundation wall onto the footer, then where the vertical wall interfaces the footer shall be prepared with a 3/4-inch, 45 degree angle tooled cant of Poly Wall Blue Barrier 2200 Joint Filler. Allow a minimum two (2) hours for the Blue Barrier 2200 to cure prior to covering it up. Do NOT prime with Poly Wall Liquid Adhesive underneath Poly Wall Blue Barrier 2200 Joint Filler applications. Do NOT use wood or fiber cant strips in substitution for the Blue Barrier 2200 Joint Filler.



POLY WALL® BUILDING SOLUTIONS:
Moisture and Air Stop Here®
888-976-POLY (7659) • www.poly-wall.com





Home Stretch™

Peel 'N Stick Membrane

Installation Instructions



STEP 4B

If Home Stretch Peel 'N Stick Membrane is continued at the base of the foundation wall onto the footer, then apply the Poly Wall Home Stretch WB Liquid Adhesive at a rate of 350-400 SF / gal by lamb's wool roller or by brush to a cleaned, dust-free ICF substrate surface to provide a tacky adhesive surface for the Home Stretch Peel 'N Stick Membrane installation. It is important to note that the Poly Wall Home Stretch WB Liquid Adhesive **MUST** be tacky to the touch on the substrate wall prior to the Home Stretch Peel 'N Stick Membrane installation.



STEP 4C

If Home Stretch Peel 'N Stick Membrane is continued at the base of the foundation wall onto the footer, then apply a 12-inch wide strip of Home Stretch Detail Tape over the Blue Barrier Joint Filler 2200 cant. Prior to installing the Home Stretch Detail Tape, apply Poly Wall Home Stretch WB Liquid Adhesive at a rate of 350 – 400 SF / gal by lamb's wool roller or by brush to a cleaned, dust-free substrate surface to provide a tacky adhesive surface for the Home Stretch Detail Tape to bond to the wall and the horizontal face of the footer. Again, it is important to note that the Poly Wall Home Stretch WB Liquid Adhesive **MUST** be tacky to the touch on the substrate wall prior to the Home Stretch Detail Tape installation. Center the Home Stretch Detail Tape along the joint's axis; and press, or roll, firmly to achieve a complete seal.



POLY WALL® BUILDING SOLUTIONS:
Moisture and Air Stop Here®
888-976-POLY (7659) • www.poly-wall.com





Home Stretch™

Peel 'N Stick Membrane

Installation Instructions

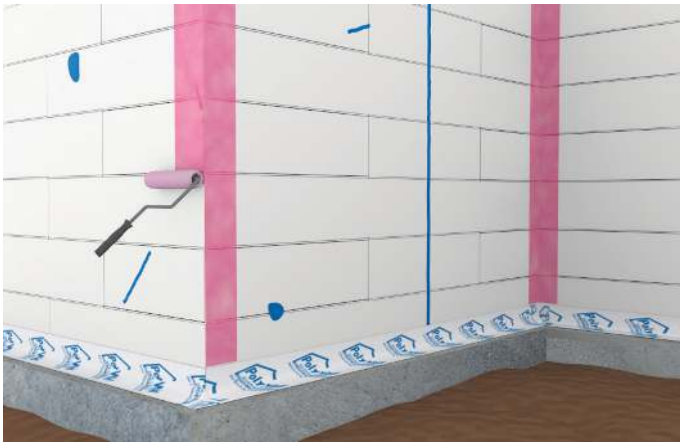

STEP 5A

All inside and outside corners shall be treated with a 12-inch wide strip of Home Stretch Detail Tape. First apply Poly Wall Home Stretch WB Liquid Adhesive at a rate of 350 – 400 SF / gal by lamb's wool roller or by brush to a cleaned, dust-free substrate surface to provide a tacky adhesive surface for the Home Stretch Detail Tape to bond to the wall. Again, it is important to note that the Poly Wall Liquid Adhesive **MUST** be tacky to the touch on the substrate wall prior to the Home Stretch Detail Tape installation.



STEP 5B

Center the Home Stretch Detail Tape along the joint's axis; and press, or roll, firmly to achieve a complete seal. As an alternative to the Home Stretch Detail Tape at all inside and outside corners, a 3/4-inch, 45 degree angle tooled cant of Poly Wall Blue Barrier 2200 Joint Filler is acceptable. Allow a minimum two (2) hours for the Blue Barrier 2200 to cure prior to covering it up. Do NOT prime with Poly Wall Liquid Adhesive underneath Poly Wall Blue Barrier 2200 Joint Filler applications. Do NOT use wood or fiber cant strips in substitution for the Blue Barrier 2200 Joint Filler.



POLY WALL® BUILDING SOLUTIONS:
Moisture and Air Stop Here®
888-976-POLY (7659) • www.poly-wall.com





Home Stretch™

Peel 'N Stick Membrane

Installation Instructions



STEP 6

Apply the Poly Wall Home Stretch WB Liquid Adhesive at a rate of 350 – 400 SF / gal by lamb's wool roller or by brush to a cleaned, dust-free ICF substrate surface to provide a tacky adhesive surface for the Home Stretch Peel 'N Stick Membrane installation. It is important to note that the Poly Wall Liquid Adhesive **MUST** be tacky to the touch on the substrate wall prior to the Home Stretch Peel 'N Stick Membrane installation. Re-prime all areas of the ICF substrate wall where the Home Stretch Peel 'N Stick Membrane material is not applied within the same working day as the Poly Wall Home Stretch WB Liquid Adhesive.



STEP 7

Align and apply the Home Stretch Peel 'N Stick Membrane vertically in sections of 8 feet in length or less, starting from the lower foundation wall base and rising to the top using the 6-inch overlap, shingling down on each ply of membrane. On walls higher than 8 feet, apply two or more sections of Home Stretch Peel 'N Stick Membrane with the upper section overlapping the lower. Use heavy hand pressure while smoothing out the Home Stretch Peel 'N Stick Membrane surface as its applied; and use a hard, narrow, hand-held roller to firmly adhere the material for a complete bond as it is placed on the vertical surfaces. When continuing the Home Stretch Peel 'N Stick Membrane materials above grade to reach the top of foundation wall, apply Poly Wall Aluma Flash PLUS or metal flashing over all of the Home Stretch Peel 'N Stick Membrane above grade, with its lower edge a minimum of four (4) inches below grade, to protect the installed Home Stretch Peel 'N Stick Membrane from UV exposure beyond its 30 day limit.



POLY WALL® BUILDING SOLUTIONS:
Moisture and Air Stop Here®
888-976-POLY (7659) • www.poly-wall.com





Home Stretch™

Peel 'N Stick Membrane

Installation Instructions



STEP 8

Home Stretch Peel 'N Stick Membrane side laps shall be 2-1/2 inches minimum. Staggered end laps shall be 6 inches minimum.



STEP 9

All Home Stretch Peel 'N Stick Membrane wall terminations shall receive a termination bar (supplied by others). Firmly press the termination edge with a hard, narrow, hand-held roller; install the termination bar with fasteners, and then cover the membrane edge and termination bar with a tooled bead of Blue Barrier 2200 Joint Filler as a termination protection.



POLY WALL® BUILDING SOLUTIONS:
Moisture and Air Stop Here®
888-976-POLY (7659) • www.poly-wall.com





Home Stretch™

Peel 'N Stick Membrane

Installation Instructions

- Inadequately lapped seams and damaged areas shall be cleaned, primed, and patched with Home Stretch Detail Tape, extending the repair coverage at least 6 inches in each direction beyond the defect.
- Fishmouths and/or severe wrinkles shall be slit, flaps overlapped, and repaired with a Home Stretch Detail Tape patch.
- Puncture all air blisters, expel the air, prime and cover with a Home Stretch Detail Tape patch. Seal all Home Stretch Detail Tape edges with 30 mils tooled of Blue Barrier 2200 Joint Filler.
- Home Stretch Peel 'N Stick Membrane will be adversely affected by prolonged or constant ultraviolet radiation (UV) exposure longer than 30 days. For periods of (UV) exposure greater than 30 days, remove and reapply all uncovered/ exposed Home Stretch Peel 'N Stick Membrane.



STEP 10

Install Poly Wall's Arroyo brand of Protection and Drainage Board accessory products over the complete and continuous Home Stretch Peel 'N Stick Membrane waterproofing system; or provide another protective board by others, and then backfill in a non-destructive manner.



POLY WALL® BUILDING SOLUTIONS:
Moisture and Air Stop Here®
888-976-POLY (7659) • www.poly-wall.com

